

CUSTOMISED COMPACT AIR HANDLING UNITS

# AmberAir

Compact CXH

**SALDA**  
WWW.SALDA.LT



**QUALITY  
IN 2 WEEKS**



# AmberAir Compact CXH



AmberAir Compact CXH air handling units combine flexibility, fast delivery terms, and exclusive quality. Using 3D modelling software it's easy to create individual air handling solutions from more than 2000 various combinations. High quality components from leading EU manufacturers, top class casing, and innovative control board ensure durability, efficient performance, and silent operation.

## 7 REASONS TO CHOOSE AmberAir CXH

- › Over 2000 combinations;
- › The best casing properties: D1, L1, F9, T2, TB1;
- › Outdoor version as standard: Tested at condition from -35° C to +40° C, RH90%;
- › 3D modeling software with LCC calculations\* and export to Autodesk Revit;
- › High efficiency: 92% HR, EC fans, smart demand-ready control;
- › Silent performance: casing radiated sound power level – from 59 to 69 dBA;
- › Eurovent certification.

**AmberAir Compact CXH IS AN IDEAL AIR HANDLING SOLUTION FOR RECONSTRUCTION OR NEW BUILDING PROJECTS SUCH AS:**



Schools



Offices



Retail stores



Hotels



Industry

\* - with QIV 2017.

# COMPACT, POWERFUL AND EFFICIENT

Due to their compact size, you can easily find a place for an AmberAir Compact in auxiliary premises or on the roof:

## Compact 1-5 CXH

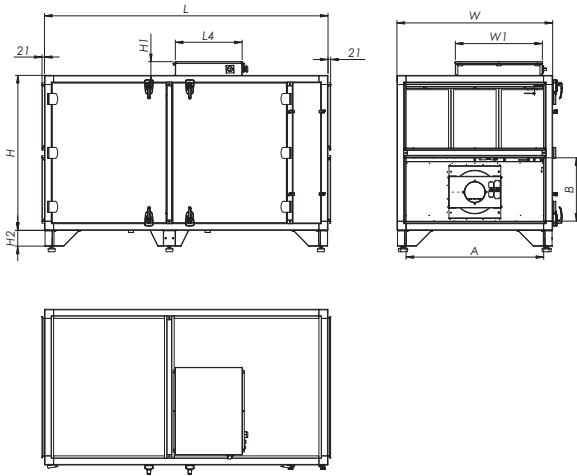

## Compact 6-7 CXH

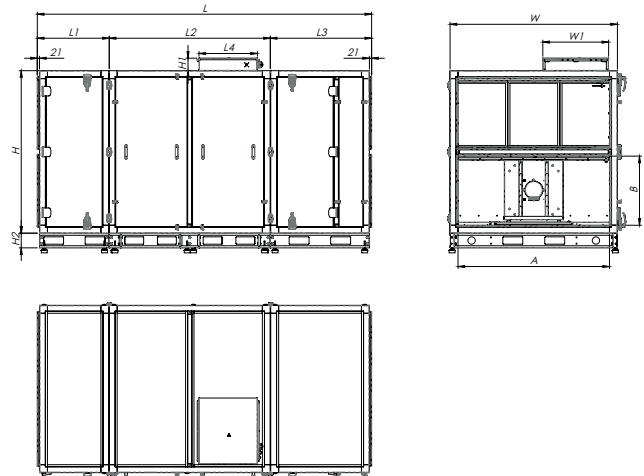

Unit	Dimensions [mm]														Weight, [kg]
	L	L1	L2	L3	W	H	L4	Control box		Legs		Connection			
								W1	H1	H2	A	B			
1-CXH	1796	-	-	-	850	950		624	120	130	700	395.5	222		
2-CXH	2195	-	-	-	860	1210		624	120	130	707	489.5	272		
3-CXH	2350	-	-	-	895	1285		624	120	130	743	526.5	325		
4-CXH	2350	-	-	-	1220	1285	550	721	114	130	1070	526.5	380		
5-CXH	2350	-	-	-	1290	1285		721	114	130	1139	526.5	428		
6-CXH	3147	685	1540	965	1596	1550		624	120	140	1445	659.5	762		
7-CXH	3215	720	1540	1000	1961	1550		624	120	140	1810	659.5	890		

## AmberAir Compact CXH: AIRFLOWS AND SIZES

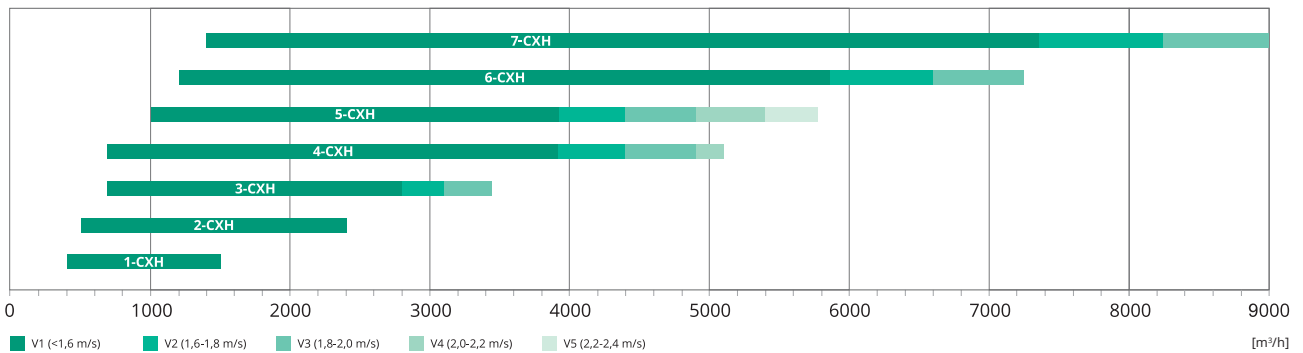

## 5 EFFICIENCY BONUSES FOR YOUR PROJECT

AmberAir Compact CXH provides top energy savings in its class:



Up to 92%  
heat recovery



Efficient  
EC fans



External  
leakage <1%



Demand control  
ready ventilation\*



Modulating control  
e-heater

\* Other comfort sensors (CO<sub>2</sub>, presence, RH) are available as accessories.

# OUTSTANDING

## AmberAir Compact CXH DESIGN



### 1. Counter-flow aluminium heat exchanger:

- > Efficiency up to 92%;
- > Separated supply and exhaust air: virtually no moisture transfer, no mixing;
- > Low maintenance;
- > Pressure relays - anti-frost protection for heat exchanger.

### 2. Integrated advanced MCB control board:

- > Demand control ready ventilation;
- > Control by remote controllers, PC via MB-Gateway, SALDA AIR application via WiFi or BMS (Mod-Bus);
- > Fire damper control and testing;
- > El. heater/preheater 0-10V control;
- > Water heater/preheater control and protection;
- > DX/water cooler, air dampers control;
- > Constant airflow mode.

### 3. SD50+ casing features:

- > Galvanized steel with powder coating panels;
- > Aluminium frame;
- > Thermal insulation: polyurethane 45 mm;
- > Thermal breaking profiles with 25 mm plastic strips;
- > Profiles internally rounded for easy cleaning.

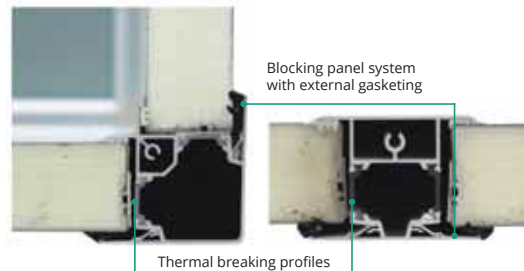

4. 3 bypass types: 100%, with recirculation or segmented.

5. Efficient EC fans with a backward curved impellers: 2 versions.

6. Stainless steel drip tray - high draining efficiency - 98% (5 l/m<sup>2</sup> at 20 min).

7. 4 air temperature sensors (supply, extract, outdoor and exhaust).

### 8. Heater:

- > Integrated modulating control electric heater (signal 0-10V);
- > Integrated water heater. Available accessories for anti-frost protection.

### 9. Filters:

- > Stitched pocket filters (external box) or panel filters (integrated);
- > Class: G4/M5/F7;
- > filter pollution monitoring: pressure switches and timer.



# SD50+ CASING PROPERTIES

THE BEST COMPACT UNIT CASING ON THE MARKET

Model	Casing strength class	Casing air leakage class at 400 Pa	Casing air leakage class at 700 Pa	Filter bypass leakage class	Thermal transmittance class	Thermal bridging factor class
SD50+	D1(M)	L1(M)	L1(M)	F9(M)	T□	TB1

## YOUR BONUSES:

- › Casing strength class D1 indicates long service life;
- › Casing air leakage class L1 guarantees lower than 1% air loss;
- › Filter by-pass leakage class F9 ensures that all air is cleaned by filters;
- › Thermal transmittance T2 and thermal bridging TB1 eliminate risk of condensation on the unit walls.

## ADVANCED ANTI-FROST PROTECTION

WITH BY-PASS

Smart anti-frost system allows the operation of AmberAir Compact units without preheater even at low temperatures□

- › -23°□□ with 100% by-pass;
- › -30°□□ with segmented by-pass.

\* - with appropriate water post-heater.

## TECHNICAL DATA

PRODUCT CODE

**AmberAir Compact**   3   CX   H   SD50+   R   F1   B1   W1   C1   P

①   ②   ③   ④   ⑤   ⑥   ⑦   ⑧   ⑨   ⑩   ⑪

①	<b>Product range - trademark</b>	⑦	<b>Fan type</b> F1 - standard; F2 - more powerful; F3 - standart 3x230V; F4 - more powerful 3x230V
②	<b>Unit size</b> 1 - first size; 7 - last size.	⑧	<b>Bypass damper</b> B1 - 100%; B2 - 100% with recirculation; B3 - segmented.
③	<b>Heat exchanger</b> CX - counter-flow.	⑨	<b>Heater</b> W1/W2 - water (1 - lower capacity, 2 - higher capacity); E1/E2/E3/E4 - electrical (1 - lower capacity, 2 - higher capacity, 3 - lower capacity 3x230V, 4 - higher capacity 3x230V).
④	<b>Casing</b> H- horizontal.	⑩	<b>Control</b> C1 - MCB control board; C2 - prewiring only; C3 - MCB + 3x230V.
⑤	<b>Model box</b> SD50+ - premium;	⑪	<b>Filter</b> P - panel; B - bag.
⑥	<b>Service side</b> R - right L - left		

## ELECTRICAL DATA

Unit	Max. electric power input of fans, kW		Phase/voltage/frequency of fan, f/VAC/Hz		Electric power input of electrical heater, kW		Phase/voltage/frequency of electrical heater, f/VAC/Hz		Max. power consumption, kW					
	F1	F2	F1	F2	E1	E2	E1	E2	F1 E1	F1 E2	F2 E1	F2 E2	F1 W1/2	F2 W1/2
1-CXH	0.76	0.94	1~/230/50	1~/230/50	□	3	1~/230/50	1~/230/50	2.76	3.76	2.94	3.94	1.16	1.34
□-□□□	0.94	1.43	1~/230/50	1~/230/50	3	4	1~/230/50	1~/230/50	3.94	4.54	4.43	5.03	1.44	1.93
3-CXH	1.43	2.56	1~/230/50	1~/230/50	4	6	3~/400/50	3~/400/50	5.03	7.43	6.16	8.56	2.03	3.16
4-□□□	2.56	3.80	1~/230/50	3~/400/50	6	7	3~/400/50	3~/400/50	8.56	9.76	9.80	11.00	3.26	4.50
5-CXH	3.80	4.55	3~/400/50	3~/400/50	7	9	3~/400/50	3~/400/50	11.00	12.80	11.75	13.55	4.60	5.35
6-CXH	4.55	5.68	3~/400/50	3~/400/50	9	9	3~/400/50	3~/400/50	13.55	13.55	14.68	14.68	5.45	6.58
7-CXH	5.68	6.81	3~/400/50	3~/400/50	12	15	3~/400/50	3~/400/50	17.68	20.68	18.81	21.81	6.68	7.81

# AIR PERFORMANCE\*

SUPPLY AIR FLOW

— Performance  
 — Power consumption

1-CXH

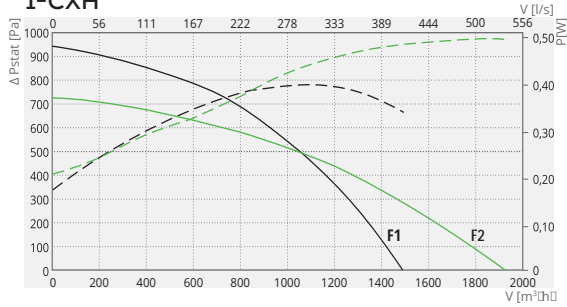

TEMPERATURE EFFICIENCY

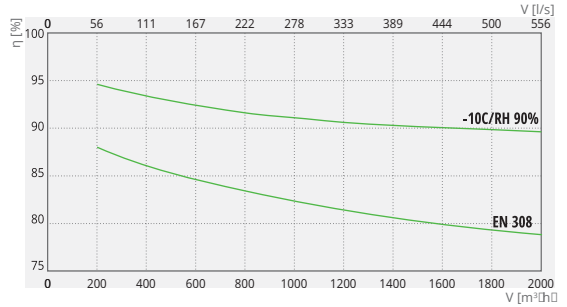

2-CXH

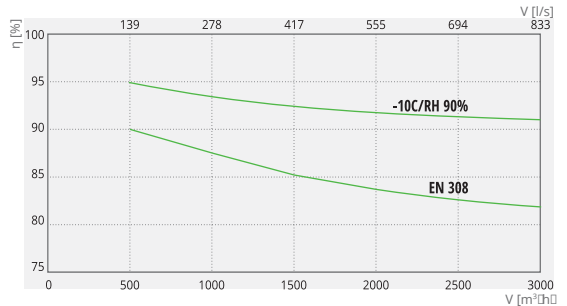
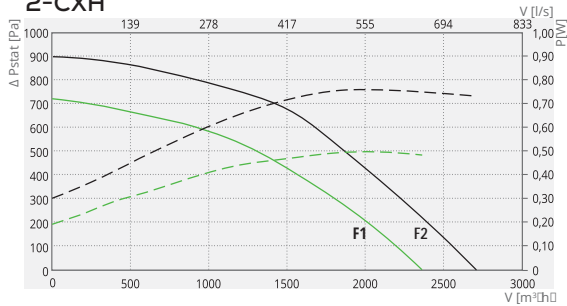

3-CXH

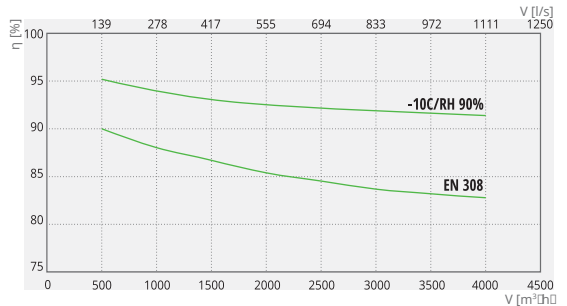
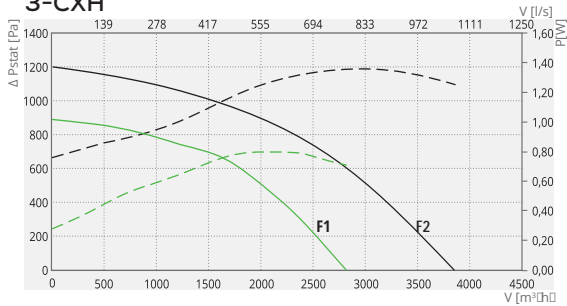

4-CXH

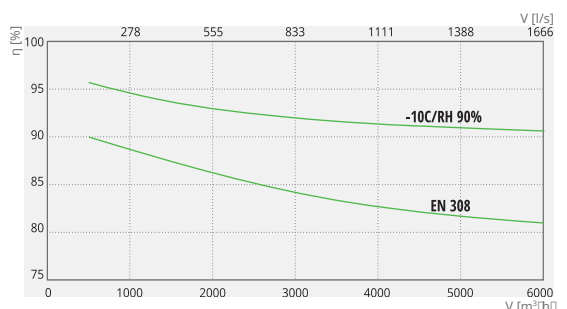
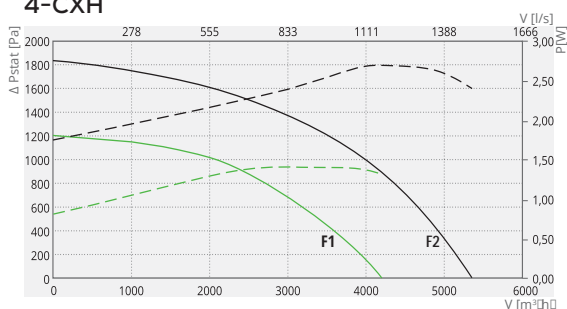

5-CXH

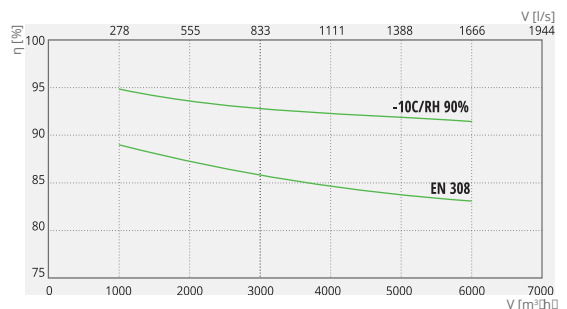
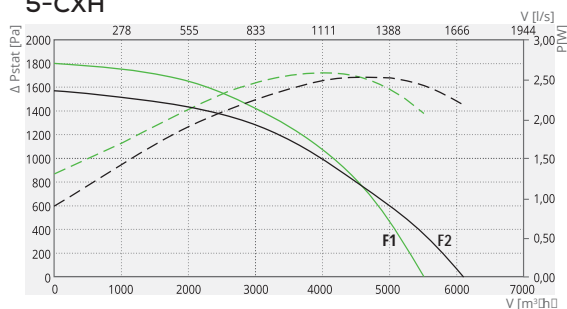

\* - Airflow curve with clean filter  
 Fan type (F1 - standard, F2 - more powerful)

### 6-CXH

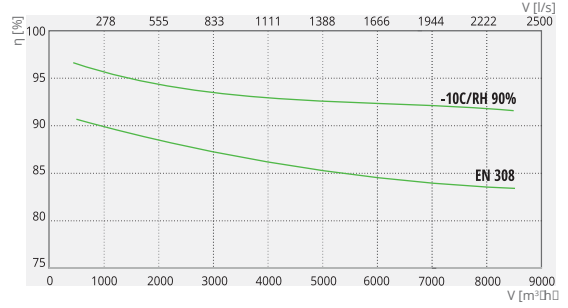
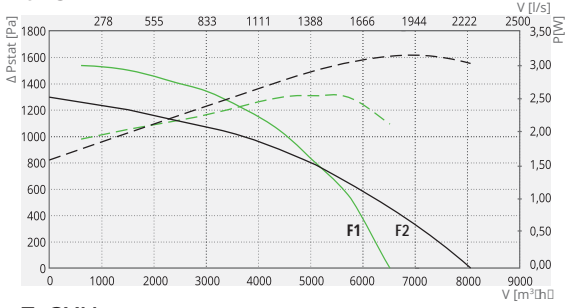

### 7-CXH

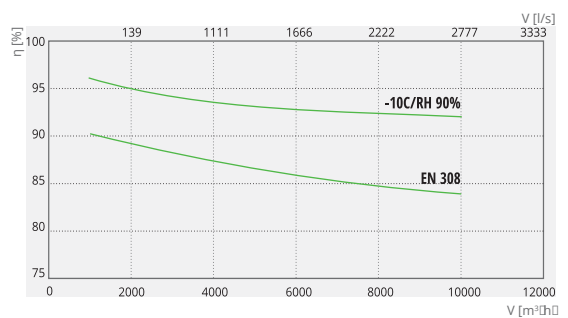
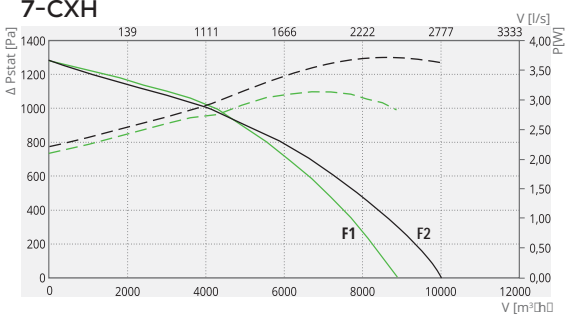

\*- Airflow curve with clean filter  
Fan type (F1 - standard, F2 - more powerful)

## CONNECTION DIAGRAM

### Version with an integrated electrical heater

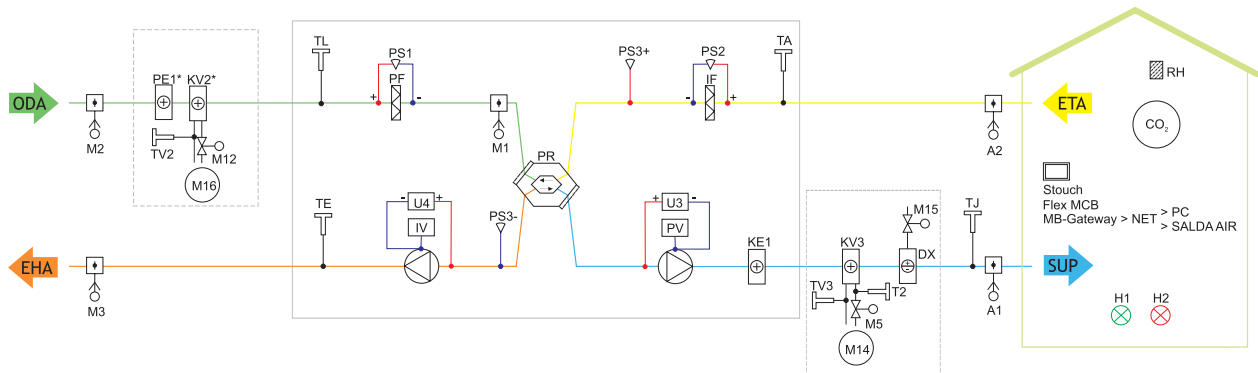

### Version with an integrated water heater

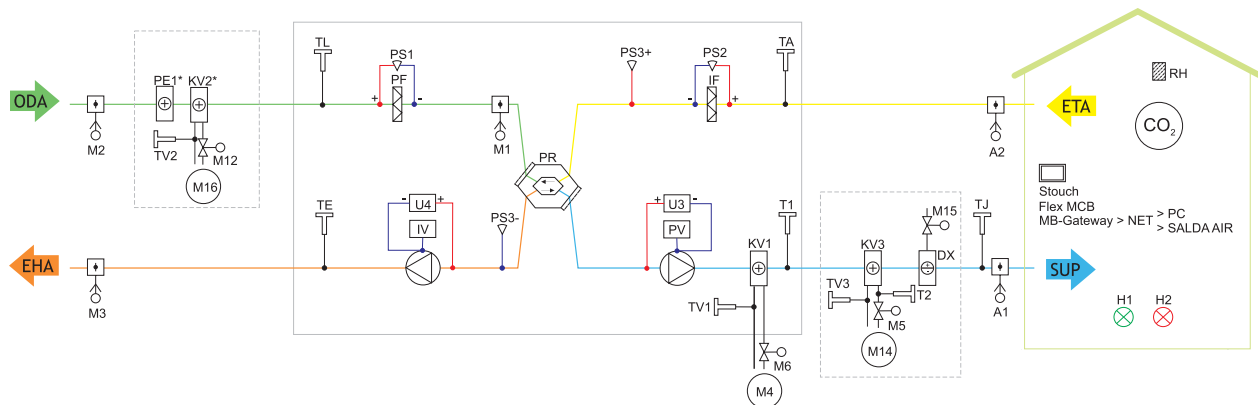

#### Symbols

	□ outdoor air		Exhaust air		Ventilated premises
	Extract air		Supply air		



List of Components			
PR	Plate heat exchanger	M15	DX cooler valve motor <sup>□□</sup>
PV	Supply air fan	M16	Water preheater circulation pump
IF	Filter for extract air	A1	Fire alarm damper actuator
PF	Filter for supply air	A2	Fire alarm damper actuator
IV	Exhaust air fan	TJ	Supply air temperature sensor
KE1	Electric heater	TL	□ outdoor air temperature sensor
PE1*	Electric pre-heater	TE	Exhaust air temperature sensor
KV1	Water heater (reverse mode available)	TA	Extract air temperature sensor
KV2*	Water pre-heater	TV1	Water heater water temperature sensor
KV3	Water cooler	TV2	Water pre-heater water temperature sensor
DX	DX cooler	TV3	Water cooler water temperature sensor
M1	Actuator for by-pass damper	T1	Water heater thermostat
M2	Actuator for outdoor air damper	T2	Water heater/cooler switching thermostat
M3	Actuator for exhaust air damper	PS1	Supply air filter pressure switch
M4	Water heater circulation pump	PS2	Extract air filter pressure switch
M5	Water cooler valve motor	PS3	Heat exchanger anti-frost pressure switch
M6	Water heater valve motor	U3	Supply air fan pressure sensor
M12	Water preheater valve motor	U4	Extract air fan pressure sensor
M14	Water cooler circulation pump <sup>□□</sup>		
List of external sensors, inputs/outputs and controllers			
RH	RH sensor	PC	□omputer
CO <sub>2</sub>	□□ □ sensor	FA	Fire alarm
Stouch	Remote control panel	FPP	Fireplace protection
Flex MCB	Remote control panel		System mode switch (START/STOP)
MB-Gateway	Network module		Fans speed switch (BOOST)
SaldaAir	Mobile application	H1	□ peration indication output
NET	Network	H2	□ alarm indication output

\* - only one preheater can be connected.  
 \*\* - only one cooler can be connected.

## ACCESSORIES

### MB-GATEWAY NETWORK MODULE



Unit	Name	Art No.
1-CXH		
□-□□□		
3-CXH		
4-□□□	MB-GATEWAY	PRGPU082
5-CXH		
6-CXH		
7-CXH		

### WIRELESS NANO ROUTER TL-WR802N



Unit	Name	Art No.
1-CXH		
□-□□□		
3-CXH		
4-□□□	WIRELESS NANO ROUTER TL-WR802N	PRGPU105
5-CXH		
6-CXH		
7-CXH		

### STOUCH REMOTE CONTROLLER



Unit	Name	Art No.
1-CXH		
□-□□□		
3-CXH		
4-□□□	STOUCH	PRGPU051
5-CXH		
6-CXH		
7-CXH		



FLEX MCB CONTROL PANEL



Unit	Name	Art No.
1-CXH		
0-000		
3-CXH		
4-000	FLEX MCB	PRGPU107
5-CXH		
6-CXH		
7-CXH		

CO<sub>2</sub> SENSORS



Unit	Room	Art No.	Duct	Art No.
1-CXH				
0-000				
3-CXH				
4-000	S-RCO2-F2	ZAKKT0048	0-0000	ZAKKT0049
5-CXH				
6-CXH				
7-CXH				

RELATIVE HUMIDITY SENSOR



Unit	Duct	Art No.	Room	Art No.
1-CXH				
0-000				
3-CXH				
4-000	S-KFF-U	ZAKKT0051	S-KFF-U-D-F2	ZAKKT0050
5-CXH				
6-CXH				
7-CXH				

DUCT SMOKE DETECTOR



Unit	Name	Art No.
1-CXH		
0-000		
3-CXH		
4-000	UG3A40	ZAKKT0110
5-CXH		
6-CXH		
7-CXH		

PRESENCE DETECTOR



Unit	Name	Art No.	Name	Art No.
1-CXH				
0-000				
3-CXH				
4-000	IR24-P	ZAKJT019	IR24-PC	ZAKJT020
5-CXH				
6-CXH				
7-CXH				

MOTION DETECTOR



Unit	Name	Art No.
1-CXH		
0-000		
3-CXH		
4-000	PATROL_701	ZAKJT021
5-CXH		
6-CXH		
7-CXH		

DAMPER ACTUATOR



Unit	Name	Art No.	Name	Art No.
1-CXH	NM230A-TP 1	ZAKP0055	TF230 (with spring)	ZAKP0063
□-□□□	NM230A-TP 1	ZAKP0055	TF230 (with spring)	ZAKP0063
3-CXH	NM230A-TP 1	ZAKP0055	TF230 (with spring)	ZAKP0063
4-□□□	NM230A-TP 1	ZAKP0055	LF230	ZAKP0039
5-CXH	NM230A-TP 1	ZAKP0055	LF230	ZAKP0039
6-CXH	NM230A-TP 1	ZAKP0055	NF230A	ZAKP0051
7-CXH	NM230A-TP 1	ZAKP0055	NF230A	ZAKP0051

SWITCH BUTTON



Unit	Name	Art No.
1-CXH	SWITCH 774451_774411	ZEPSM001
□-□□□		
3-CXH		
4-□□□		
5-CXH		
6-CXH		
7-CXH		

ENERGY METER



Unit	Name	Art No.	Name	Art No.	Name	Art No.
1-CXH	Energy analyzer EM23 (PULSE)	ZAKKT0118	Energy analyzer EM23 (PULSE+MODBUS)	ZAKKT0119	Energy analyzer EM24 (M-BUS)	ZAKKT0121
□-□□□	Energy analyzer EM23 (PULSE)	ZAKKT0118	Energy analyzer EM23 (PULSE+MODBUS)	ZAKKT0119	Energy analyzer EM24 (M-BUS)	ZAKKT0121
3-CXH	Energy analyzer EM210 (PULSE)	ZAKKT0116	Energy analyzer EM210 (PULSE+MODBUS)	ZAKKT0120	Energy analyzer EM24 (M-BUS)	ZAKKT0121
4-□□□	Energy analyzer EM210 (PULSE)	ZAKKT0116	Energy analyzer EM210 (PULSE+MODBUS)	ZAKKT0120	Energy analyzer EM24 (M-BUS)	ZAKKT0121
5-CXH	Energy analyzer EM210 (PULSE)	ZAKKT0116	Energy analyzer EM210 (PULSE+MODBUS)	ZAKKT0120	Energy analyzer EM24 (M-BUS)	ZAKKT0121
6-CXH	Energy analyzer EM210 (PULSE)	ZAKKT0116	Energy analyzer EM210 (PULSE+MODBUS)	ZAKKT0120	Energy analyzer EM24 (M-BUS)	ZAKKT0121
7-CXH	Energy analyzer EM210 (PULSE)	ZAKKT0116	Energy analyzer EM210 (PULSE+MODBUS)	ZAKKT0120	Energy analyzer EM24 (M-BUS)	ZAKKT0121

SILENCERS FOR CIRCULAR DUCTS



Unit	Name	Art No.
1-CXH	MUTE 315X900	GSOMUTE024
□-□□□	AKS 400-630-10	GSOAKS046
3-CXH	AKS 400-630-10	GSOAKS046
4-□□□	AKS 500-630-10	GSOAKS020
5-CXH	AKS 630-800-10	GSOAKS053
6-CXH	AKS 630-800-10	GSOAKS053
7-CXH	AKS 710-800-10	GSOAKS126

WATER COOLER



Unit	Name	Art No.
1-CXH	AVA 315	GSIAVA006
□-□□□	AVA 400	GSIAVA007
3-CXH	AVA 400	GSIAVA007
4-□□□	AVA 500	GSIAVA015
5-CXH	AVA 630	GSIAVA008
6-CXH	AVA 630	GSIAVA008
7-CXH	AVA 710	GSIAVA009

#### DX COOLER



Unit	Name	Art No.
1-CXH	AVA-DX 315	GSIAVA010
□-□□□	AVA-DX 400	GSIAVA011
3-CXH	AVA-DX 400	GSIAVA011
4-□□□	AVA-DX 500	GSIAVA012
5-CXH	AVA-DX 630	GSIAVA013
6-CXH	AVA-DX 630	GSIAVA013
7-CXH	AVA-DX 710	GSIAVA014

#### FLEXIBLE CONNECTION

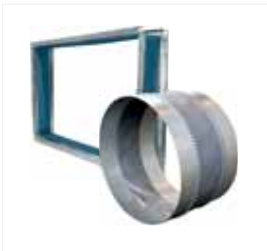

Unit	Name	Art No.	Name	Art No.
1-CXH	LJ/E 69,5x35,5	GLJLJ/E044	LSVF 315	GVELSVF005
□-□□□	LJ/E 70x48,5	GLJLJ/E045	LSVF 400	GVELSVF007
3-CXH	LJ/E 73,5x52	GLJLJ/E046	LSVF 400	GVELSVF007
4-□□□	LJ/E 106x52	GLJLJ/E047	LSVF 500	GVELSVF009
5-CXH	LJ/E 113,5x52	GLJLJ/E048	LSVF 630	GVELSVF010
6-CXH	LJ/E 144x65,5	GLJLJ/E049	LSVF 630	GVELSVF010
7-CXH	LJ/E 180,5x65,5	GLJLJ/E050	LSVF 710	GVELSVF018

#### SHUT-OFF DAMPER



Unit	Name	Art No.	Name	Art No.
1-CXH	SSK 695x355	GSKSSK751	SKG-A 315	GSKSKG035
□-□□□	SSK 700x485	GSKSSK752	SKG-A 400	GSKSKG037
3-CXH	SSK 735x520	GSKSSK753	SKG-A 400	GSKSKG037
4-□□□	SSK 1060x520	GSKSSK754	-	-
5-CXH	SSK 1135x520	GSKSSK755	-	-
6-CXH	SSK 1440x655	GSKSSK756	-	-
7-CXH	SSK 1805x655	GSKSSK757	-	-

#### SILENCERS FOR RECTANGULAR DUCTS



Unit	Name	Art No.
1-CXH	SSP 695x355x1000 (3x100x100)	GSOSSP216_1027
□-□□□	SSP 700x485x1000 (3x100x100)	GSOSSP216_1028
3-CXH	SSP 735x520x1000 (4x100x80)	GSOSSP216_1029
4-□□□	SSP 1065x520x1000 (5x100x100)	GSOSSP216_1030
5-CXH	SSP 1135x520x1000 (6x100x80)	GSOSSP216_1031
6-CXH	SSP 1440x655x1000 (7x100x100)	GSOSSP216_1032
7-CXH	SSP 1805x655x1000 (9x100x100)	GSOSSP216_1033

#### FILTER BOX



Unit	Name	Art No.
1-CXH	FDS-S 69.5-35.5	GFZFDS059
□-□□□	FDS-S 70-48.5	GFZFDS065
3-CXH	FDS-S 74-52	GFZFDS060
4-□□□	FDS-S 106-52	GFZFDS061
5-CXH	FDS-S 113.5-52	GFZFDS062
6-CXH	FDS-S 114-65.5	GFZFDS063
7-CXH	FDS-S 108.5-65.5	GFZFDS064

#### FLANGE ADAPTER



Unit	Name	Art No.
1-CXH	STP-CI 695x355-315	GSFSTPCI161_356
□-□□□	STP-CI 705x485-400	GSFSTPCI161_404
3-CXH	STP-CI 735x520-500	GSFSTPCI161_331
4-□□□	STP-CI 1062x520-500	GSFSTPCI161_403
5-CXH	STP-CI 1133x520-630	GSFSTPCI161_355
6-CXH	STP-CI 1440x655-630	GSFSTPCI161_407
7-CXH	STP-CI 1804x654-710	GSFSTPCI161_406

## OUTLET COVER



Unit	Name	Art No.
1-CXH	ABV 315	GFDABV0315
□-□□□	ABV 400	GFDABV0400
3-CXH	ABV 400	GFDABV0400
4-□□□	ABV 500	GFDABV0500
5-CXH	ABV 630	GFDABV0630
6-CXH	ABV 630	GFDABV0630
7-CXH	ABV 710	GFDABV0710

## ROOF



Unit	Name	Art No.
1-CXH	Roof for Compact 1 CXH	GNGPR168_1127_0
□-□□□	Roof for Compact 2 CXH	GNGPR168_1128_0
3-CXH	Roof for Compact 3 CXH	GNGPR168_1129_0
4-□□□	Roof for Compact 4 CXH	GNGPR168_1130_0
5-CXH	Roof for Compact 5 CXH	GNGPR168_1131_0
6-CXH	Roof for Compact 6 CXH	GNGPR168_1132_0
7-CXH	Roof for Compact 7 CXH	GNGPR168_1133_0

# ADVANCED CONTROL FUNCTIONS

Descriptions of functions		Descriptions of functions	
System modes	●	BMS connection	●
Weekly Schedule	●	Outdoor/Exhaust air dampers control	●
Holiday Schedule	●	Fans protection	●
Winter/Summer Mode	●	Air temperature sensors (outdoor, supply, extract, exhaust)	●
BOOST function	●	Water heater/preheater/cooler water temperature sensor	●
Protection against Dryness	○	Electrical heater/preheater On/Off or 0-10V control	●
□ight cooling	●	Water heater/preheater control and frost protection	●
Air Flow Adjustment	●	Water cooler control	○
System Monitoring	●	Water cooler reverse	●
Supply Air Temperature Control and Compensation	●	Filter Protection by switch and timer	●
System Mode Communication with an External Contactor	○	Fire Dampers control and testing	●
Fireplace function	●	DX cooler control and reverse	●
Fireplace protection (NC)	○	Recirculation	●
□□ <sub>0</sub> reduction	○	By-pass damper control	●
Relative humidity reduction	○	□onstant pressure mode	●
Fan control by pressure	●	Constant airflow mode	●
Fire Protection from an External Contactor	●	Remote control options	●
Heat Exchanger Frost Protection	●	□ontrol panel □Touch	⊕
Digital Input Configuration	●	Control panel FLEX MCB	⊕
Indication Outputs (Working indication, Alarm indication)	●	Network module MB-Gateway with web-based control software	○

○ - Requires additional components such as CO2 sensors, etc.

● - Standard functions (quantity of functions depends on the AHU), managed by BMS or remote controllers.

⊕ - Remote controllers.



Google Play store:



iTunes □pple store□



# QUALITY IS CONFIRMED BY EXTENSIVE TESTING

Every AmberAir Comact unit goes through testing in order to guarantee smooth performance in any conditions:

- › Climatic chamber: thermal efficiency and performance at climatic conditions -35° C - +40° C and anti-frost protection of heat exchanger;
- › Multi tube airflow measurement chamber: aerodynamic characteristics of fans;
- › Noise chamber: determination of sound power level.

SMART SELECTION OF SOFTWARE

## VENTMASTER V5

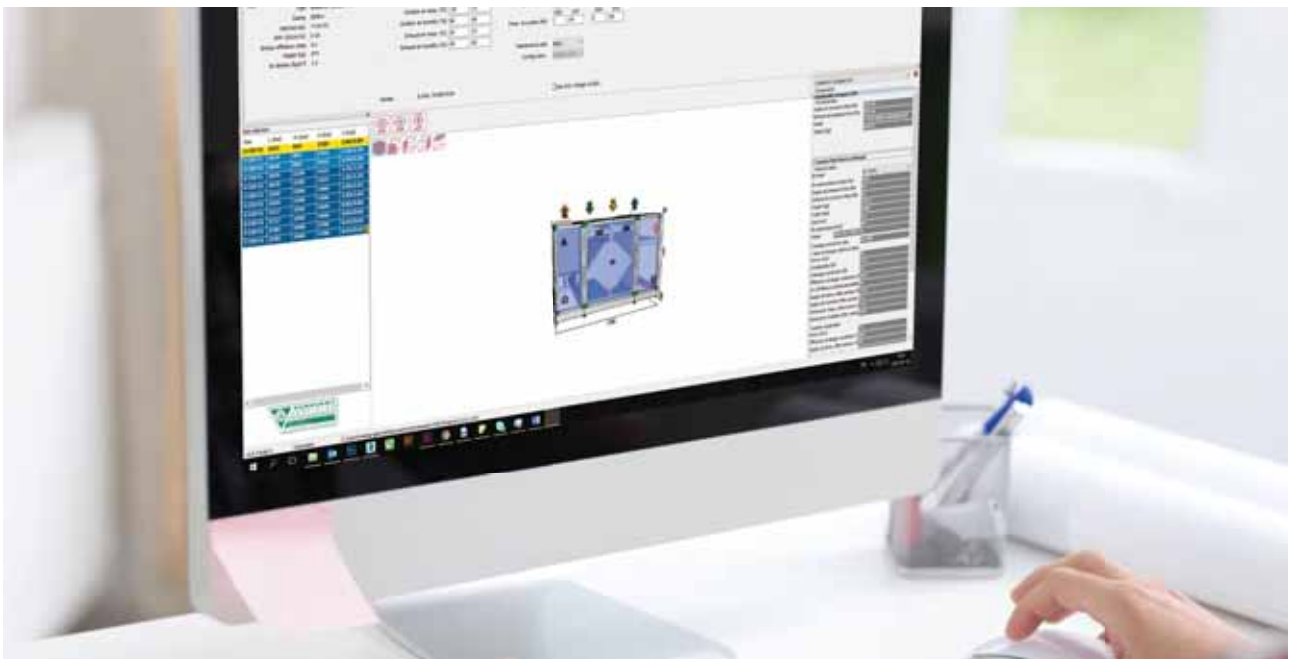

Key features:

- › 3D modelling;
- › Automatic heater capacity selection;
- › Online price calculation and ordering (for registered users);
- › Export of drawing in .DXF file;
- › Export of drawing and technical data to Autodesk Revit;
- › LCC calculation (available from QIV 2017).



VentMaster

**Software is free of charge.**

Go to [www.salda.lt](http://www.salda.lt) to get your VentMaster.

SIVENTA LAB



Tested in independent Laboratory **SIVENTA**, according EN ISO/IEC 17025.

**Performed tests:**

- › Aerodynamic.
- › Thermal.
- › Acoustic.
- › Electrical performance.
- › Sound power level.
- › Sound energy level determination.



**2 year warranty**



SALDA UAB  
Ragainės g. 100  
LT-78109 Šiauliai, Lithuania



+370 41 54 04 15  
+370 41 54 04 17



office@salda.lt  
www.salda.lt

Distributor