

## ROOF AMBERAIR COMPACT CX P

EN MOUNTING AND INSTALLATION INSTRUCTION



www.salda.lt

Raginės g. 100  
 Šiauliai LT-78109, LITHUANIA  
 +370 41 540 415  
 office@salda.lt



MAN000110



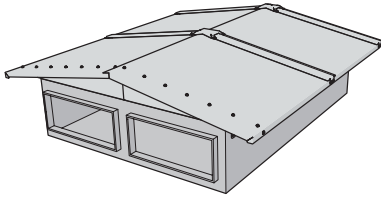

Roof Compact 1 CX P

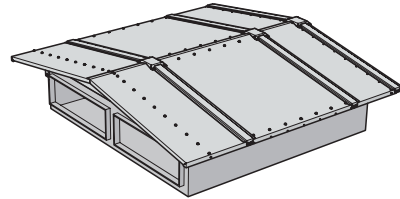

Roof Compact 2-4 CX P

**Package:**

- A. Roof segment;
- B. Roof segment;
- C. Supports;
- D. Mounting brackets (1 CX P);
- E. Mounting brackets (2-4 CX P);
- F. Cover/Hood;
- G. Roof brackets;

- H. Sealing rubber;
- I. Screw 4,2x13M DIN7504 (2-4 CX P);
- J. Washer and screw 4,8x19K DIN7504;
- K. Washer and screw 5x20 DIN7985;
- L. Brackets (2-4 CX P);
- M. Brackets (2-4 CX P).

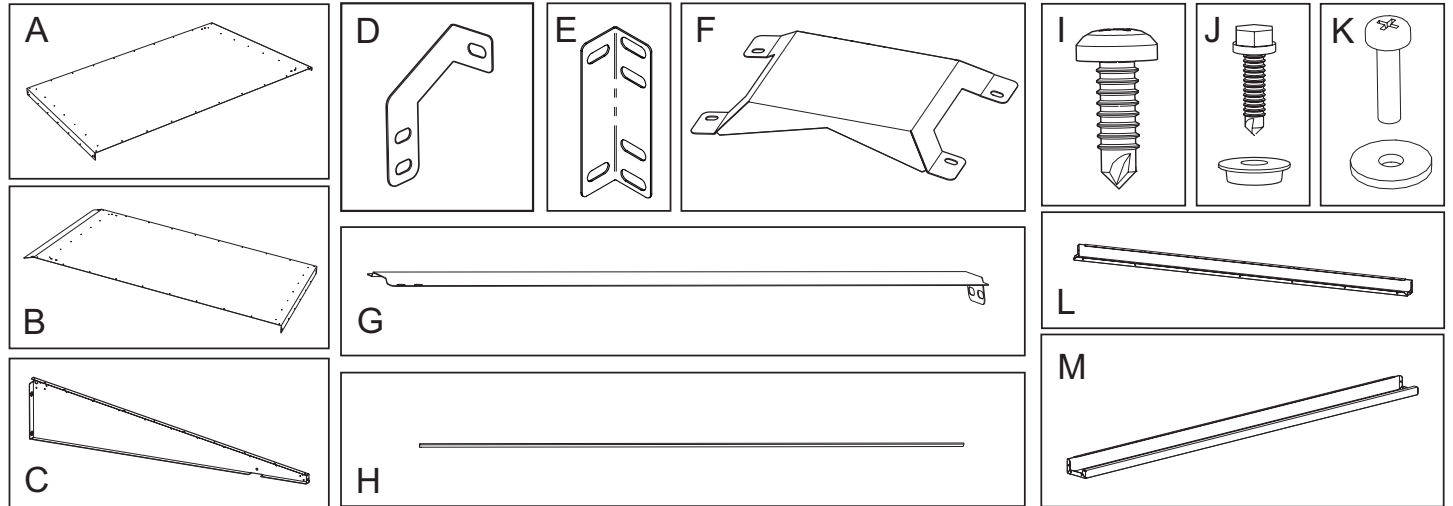

**Installation:**

- Assembly roof segments separately from the unit.
- Final assembly must be made on the unit.
- Connect two triangle segments with each other as shown in *figure 3* (use **K** screws).
- For 2-4 CX P screw additional supporting parts at the end of the triangle segments as shown in *figure 8* (use **I** screws).
- Add the top cover plates on the connected triangle segments (top cover plates must be overlap for each other) and screw with bolts as shown in *figure 4* (use **I** and **J** screws).
- Add connected roof segment on the unit.
- Fix supporting brackets to the roof and to the unit (use **K** screws).
- Add sealing tape on the long cover part segment as shown in *figure 12*.
- Add long cover parts on the roof and fix on the top and on the bottom as shown in *figure 13* (use **K** screws).
- Add final top cover parts on the roof as shown in *figure 15* (use **K** screws).

